

# MODEL HN2 NIBBLER

MAXIMUM DUTY 10 GAUGE CAPACITY



KETT TOOL COMPANY  
5055 Madison Road, Cincinnati, Ohio 45247-1494  
513/271-0333 Fax 513/271-5318  
[www.kett-tool.com](http://www.kett-tool.com)  
e-mail [sales@kett-tool.com](mailto:sales@kett-tool.com)

## SPECIFICATIONS

### MAXIMUM MATERIAL THICKNESS (CUTTING CAPACITY)

MILD STEEL 10 Ga. (.1345 in. / 3,42 mm)  
STAINLESS STEEL 12 Ga. (.1046 in. / 2,66 mm)  
NON-FERROUS 8 Ga. (.1644 in. / 4,18 mm)

### MAXIMUM CUTTING SPEED

90 INCHES PER MINUTE (2.3 meters per minute)

### MINIMUM CUTTING RADIUS\*

6 inches (152,4 mm)

### PHYSICAL SIZE

12-5/8" (321 mm) Long, 4-1/8"(105 mm) wide

### HEIGHT

9-3/4" inches (248 mm)

### WEIGHT

14 lbs. (6,35 kgs.)

### MOTOR

1 H.P. 110 volts 6 amp

### STARTING HOLE SIZE

1 5/8 inches (41,3 mm) in diameter

### SIZE OF CUT WIDTH

13/64" (5,16 mm)

## IMPORTANT OPERATING HINTS

1. Always disconnect power cord before attempting adjustment or maintenance.
2. Minimize air gap between stripper foot and material by adjusting the stripper position (item 16).
3. Tighten all screws and check punch and die clearance at least once daily.
4. Keep a spare punch and die in stock.
5. Turn nibbler on before engaging material.
6. When possible, spread a thin film of oil on surfaces being cut as this will greatly increase the life of the punch and die.
7. Stop machine immediately if it should jam. Never force tool. Back out punch by in serting screw driver in operating slot at rear of motor X and turning motor shaft counter clockwise.
8. Let nibbler do the work as guiding tool is all that is necessary and forcing will only cause it to operate improperly.
9. Only cut the gauge metal that is recommended or servicing and expensive part damage will occur.
10. Observe lubrication instructions.
11. Always make frequent checks on motor brushes, replacing if worn.

# FOR PORTABLE ELECTRIC TOOLS

## REPLACEMENT PARTS

When servicing, use only original KETT replacement parts.

## GENERAL SAFETY RULES FOR ALL TOOLS GROUNDED AND DOUBLE INSULATED

1. **KEEP WORK AREA CLEAN**  
Cluttered areas and benches invite accidents.
2. **AVOID DANGEROUS ENVIRONMENT**  
Keep work area well lit.
3. **KEEP CHILDREN AWAY**  
All visitors should be kept a safe distance from work area.
4. **STORE IDLE TOOLS WHEN NOT IN USE**  
Tools should be stored in a dry, high, or locked-up place out of the reach of children.
5. **DON'T FORCE TOOL**  
It will do the job better and safer at the rate for which it was designed.
6. **USE RIGHT TOOL**  
Don't force small tool or attachment to do the job of heavy-duty tool.
7. **WEAR PROPER APPAREL**  
No loose clothing or jewelry to get caught in moving parts.
8. **USE SAFETY GLASSES**  
Use safety glasses with all tools. Also face or dust mask if cutting operation is dusty.
9. **DON'T ABUSE CORD**  
Never carry tool by cord or yank it to disconnect from receptacle. Keep cord from heat, oil, and sharp edges.
10. **SECURE WORK**  
Use clamps or vise to hold work. It's safer than using your hand and it frees both hands to operate tool.
11. **DON'T OVERREACH**  
Keep proper footing and balance at all times.
12. **MAINTAIN TOOLS WITH CARE**  
Keep tools sharp and clean for best and safest performance. Follow operating instructions for adjustments, lubricating and changing accessories.
13. **DISCONNECT TOOLS**  
When not in use and before servicing or when changing accessories such as punch, die, brushes, etc.
14. **REMOVE ADJUSTING KEYS AND WRENCHES**  
Form habit of checking to see that keys and adjusting wrenches are removed from tool before turning it on.
15. **AVOID ACCIDENTAL STARTING**  
Don't carry plugged in tool with finger on switch. Be sure switch is off when plugging in.
16. **OUTDOOR USE EXTENSION CORDS**  
When tool is used outdoors, use only extension cords marked "suitable for use with outdoor appliances."  
Store indoors when not in use.

## SERVICING INSTRUCTIONS:

All repairs and maintenance of the electrical components, armature, field, switches and cords of either double insulated or grounded tools must be performed by KETT TOOL COMPANY.

# HN2 PARTS LIST

## PARTS LIST

Item #	Part #	Qty	Description
1	N3566	1	Vinyl Grip
2	N3565	1	Handle Nose Housing
3	N3518	2	Pan Head Screw W/Washer
4	N3002	1	Handle, Motor
5	N3003	1	Handle, Motor Cover
6	N3537	1	Nose Housing
7	N3057	4	Body Screw
8	N3534	1	Yoke
9	N3532	1	Dowel Pin
10	N3536	1	Plunger
11	N3533	1	Punch
12	N3574	1	Die Holder/Nose Piece
13	N3028	1	Die
14	N3058	2	Die Screw
15	N3045	2	Die Washer
16	N3030	1	Stripper
17	N3031	1	Stripper Set Screw
18	N3575	1	Punch Retainer
19	N3556	2	Punch Retainer Screw
20	N5045	2	Punch Retainer Lockwasher
21	N3538	1	Eccentric Shaft
22	N3539	1	Roller Bearing Yoke
23	178-12	1	Set Screw
24	N3040	2	Roller Bearing Eccentric Shaft
25	N3041	1	Large Helical Gear
26	N3060	1	Woodruff Key
27	N3042	1	Gear Housing
28	N3054	2	Small Ball Bearing
29	N3011	1	Ground Screw
30	AN3053	1	Small Gear Assy. (incl. pinion gear shaft and key)
31	N3001	1	Motor Housing
32	N3032	2	Brush Holder Cap Protector
33	N3016	2	Handle Nut, Self Locking
34	N3017	2	Handle Locking Screw
35	N3009	1	Switch Assy.
36	N3008	2	Switch Mounting Screw
37	N3012	2	Cord Clamp Screw
38	N3013	1	Cord Clamp
39	N6014	1	Cord Guard
40	N3015	1	Cord Assy.
41	N3004	5	Handle Cover Screw
42	N3048	1	Front Armature Bearing
43	N3021	1	Motor Armature
44	N3019	1	Motor Field
45	N3026	2	Brush Holder
46	N3044	2	Motor Brush Set
47	N3023	1	Rear Armature Bearing
48	N3025	1	Spacer
49	N3024	1	Load Spring
50	N3047	4	Field Screw
51	N3050	4	Lock Washer
52	N3049	2	Dowel Pin
53	N3055	4	Cap Screw
54	N5059	1	Button Plug
55	N3007	1	Ground Wire Retainer

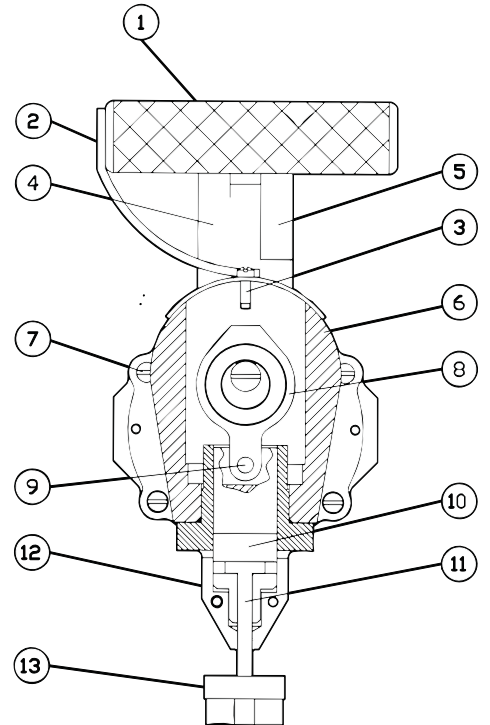

(For clarity purpose: Items 16, 17, 18, 19, 20 & 21 are not shown in this view)

### Accessories

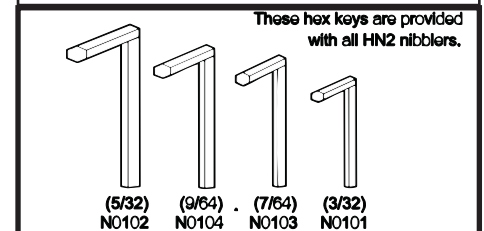

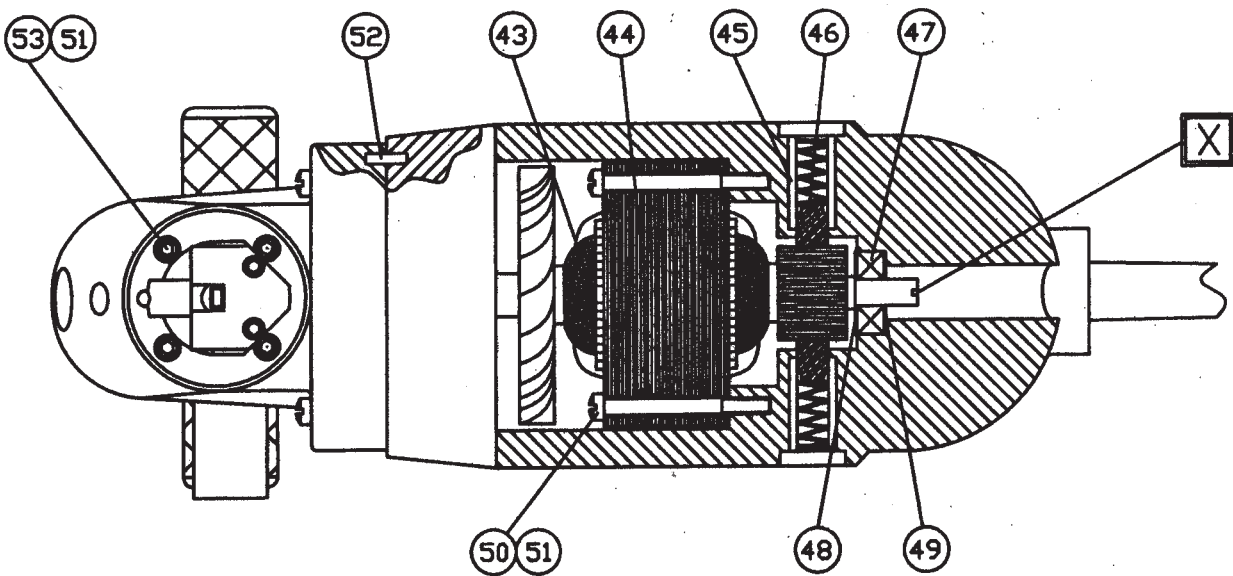
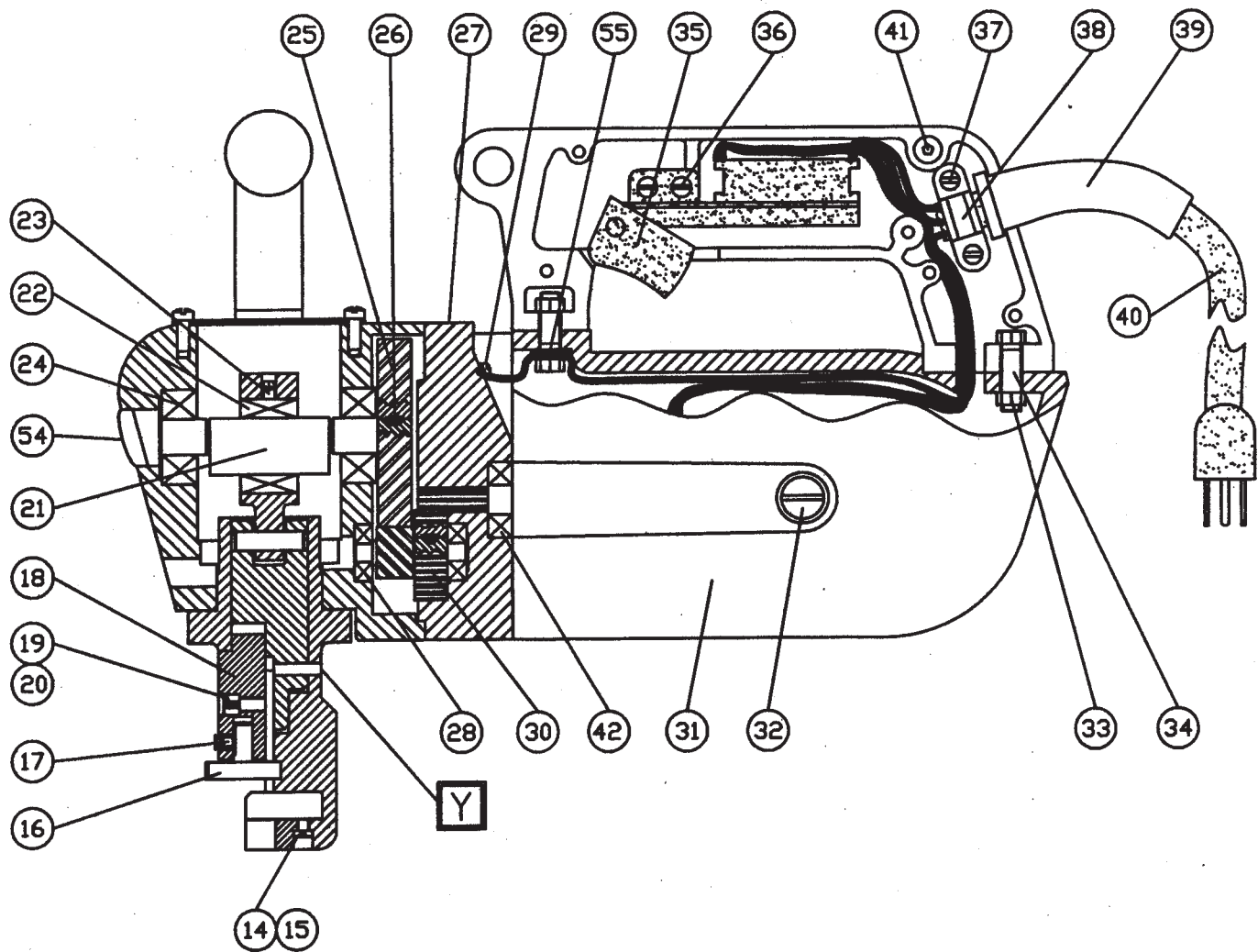

## Basic Adjustments

**Caution: Always unplug the tool before making adjustments and replacing accessories.**

## Replacing Punch

1. Insert screwdriver in slot of armature shaft X and rotate motor to allow punch removal access holes Y to line up.
2. Loosen screws (19) and pull punch retainer (18) out of the die holder (12).
3. Insert provided 3/32" hex key or similar object through the punch removal access hole Y and push the punch (11) from the plunger (10).
4. Remove any cutting particles from the T-punch grooves, punch retainer (18) and die holder (12) and re-lube.
5. Re-install punch (11) into plunger (10), re-install punch retainer (18) and re-tighten screws (19) (It may be necessary to loosen stripper set screw (17) for alignment).
6. Before running nibbler, ensure all components are properly lubricated and secure. Manually cycle motor to make sure there are no mechanical interferences between punch, die and / or with punch retainer.

**Note: the punch cannot be reground.**

## Replacing Die

1. Loosen set screw (17) and raise stripper (16) to widest opening.
2. Remove two die screw (14) and lockwashers (15).
3. Remove Die (13) by pulling it from the die holder (12).

**Caution: manually rotate motor with screwdriver to check for binding before connecting power.**

## Adjusting Stripper

1. Loosen stripper screw (17) and raise stripper (16) to widest opening.
2. Re-tighten stripper screw (17).

## Lubrication

### Gear Housing

**After 100 hours of operation or every six months:**

1. Regrease the gear assembly. Remove brush holder cap protectors (32) brush set (46) and four body screw (7).

### Punch Retainer

Apply grease to the back side of the punch retainer (18) after each removal.

**Caution: Manually rotate motor with screwdriver to check for binding before connecting power.**