

**I
N
S
T
R
U
C
T
I
O
N
M
A
N
U
A
L**

MODEL SHN NIBBLER
SUPER HEAVY DUTY 3/8" CAPACITY

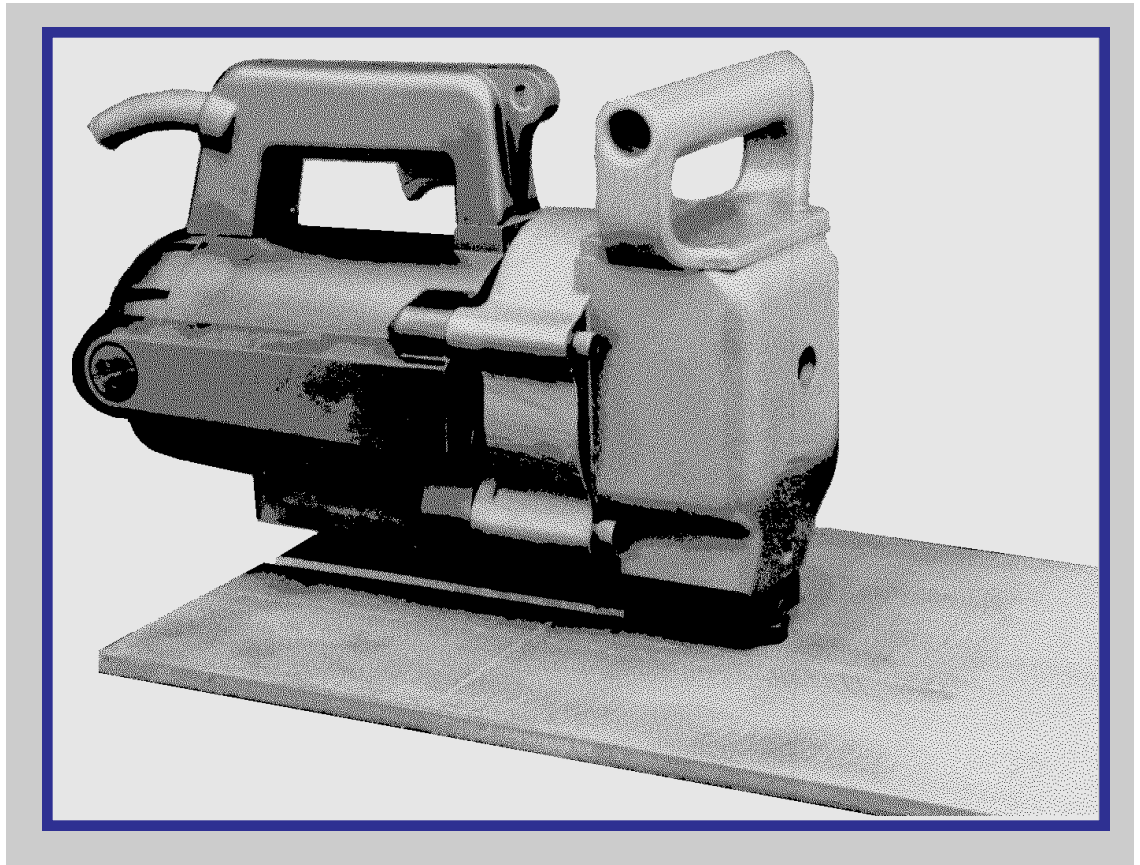

KETT TOOL COMPANY 5055 MADISON ROAD CINCINNATI, OHIO 45227-1494
513/271-0333
FAX 513/271-5318

MADE IN U.S.A.

SPECIFICATIONS

MAXIMUM MATERIAL THICKNESS (CUTTING CAPACITY)

MILD STEEL	3/8"	(.375 in. / 9.53 mm.)
STAINLESS STEEL	1/4"	(.250 in. / 6.35 mm.)
NON-FERROUS	7/16"	(.437 in. / 11.11 mm.)

MAXIMUM CUTTING SPEED

35 INCHES PER MINUTE (.9 meters per minute.)

MINIMUM CUTTING RADIUS*

12 inches (304.8 mm.)

(* Primarily designed for straight cutting.)

PHYSICAL SIZE

15" (38 mm) Long, 6"(148 mm) wide

HEIGHT

11-1/2 inches (290 mm)

WEIGHT

40 lbs. (88 Kgs.)

MOTOR

4-1/2 H.P. (2300 watts), 110 volts* 20 Amp

(*Available in 220 v at additional charge.)

STARTING HOLE SIZE

3 inches (74 mm) in diameter

SIZE OF CUT

3/8" (9.53 mm) x 1/4" (6.35 mm)

IMPORTANT OPERATING HINTS

1. **CAUTION: Always disconnect power cord before attempting adjustment or maintenance.**
2. Shim stripper to 1/16 inch above metal thickness being cut. See table "A", (Figure 4.)
3. Tighten all screws and check punch and die clearance at least once daily.
4. Keep punch and die sharp and a spare in stock.
5. Turn nibbler on before engaging material.
6. When possible, spread a thin film of oil on surfaces being cut as this will greatly extend punch and die life.
7. Always stop machine immediately if it should jam. Never force tool. Unplug tool. Back out punch by inserting screwdriver in operating slot at rear of motor and turning motor shaft counter clockwise.
8. Always let nibbler do the work as guiding tool is all that is necessary and forcing will only cause it to operate improperly.
9. Only cut the gauge metal that is recommended or servicing and expensive part damage will occur.
10. Always observe lubrication instructions.
11. Always make frequent checks on motor brushes, replacing if worn.
12. Your KETT / FENWAY model "SUPER" motor body is provided with four 5/16 -18 tapped holes on a 3 inch square bolt pattern. When bench mounted, your "SUPER" Nibbler becomes a handy tool for shaping small metal parts up to 3/8 inch thick, which may be fed into punch by hand with ease.

REPLACEMENT PARTS

When servicing, use only original KETT / FENWAY replacement parts.

FOR ALL TOOLS - GROUNDED AND DOUBLE INSULATED

1. **DISCONNECT TOOLS**
When not in use; before servicing, when changing accessories such as punch, die, brushes, etc.
2. **KEEP WORK AREA CLEAN**
Cluttered areas and benches invite accidents.
3. **AVOID DANGEROUS ENVIRONMENT**
Keep work area well lit. Do not use in a wet or damp environment.
4. **KEEP CHILDREN AWAY**
All visitors should be kept a safe distance from work area.
5. **STORE IDLE TOOLS WHEN NOT IN USE**
Tools should be stored in a dry, high, or locked-up place out of the reach of children.
6. **DON'T FORCE TOOL**
It will do the job better and safer at the rate for which it was designed.
7. **USE RIGHT TOOL**
Don't force small tool or attachment to do the job of heavy-duty tool.
8. **WEAR PROPER APPAREL**
No loose clothing or jewelry to get caught in moving parts.
9. **USE SAFETY GLASSES**
Use safety glasses with all tools. Also face or dust mask if cutting operation is dusty.
10. **DON'T ABUSE CORD**
Never carry tool by cord or yank it to disconnect from receptacle. Keep cord from heat, oil, and sharp edges.
11. **SECURE WORK**
Use clamps or vise to hold work. It's safer than using your hand and it frees both hands to operate tool.
12. **DON'T OVERREACH**
Keep proper footing and balance at all times.
13. **MAINTAIN TOOLS WITH CARE**
Keep tools sharp and clean for best and safest performance. Follow operating instructions for adjustments, lubricating and changing accessories.
14. **REMOVE ADJUSTING KEYS AND WRENCHES**
Form habit of checking to see that keys and adjusting wrenches are removed from tool before turning it on.
15. **AVOID ACCIDENTAL STARTING -**
Don't carry plugged in tool with finger on switch. Be sure switch is off when plugging in.
16. **OUTDOOR USE EXTENSION CORDS -**
When tool is used outdoors, use only extension cords marked "suitable for use with outdoor appliances."
Store indoors when not in use.

SERVICING INSTRUCTIONS:

All repairs and maintenance of the electrical components, armature, field, switches and cords of either double insulated or grounded tools must be performed by an authorized service center.

SUPER PARTS LIST

PARTS LIST

Item No.	Part No.	Qty.	DESCRIPTION
1	N7065	1	Handle
2	N7018	4	Screw, Handle
3	N7057	4	Screw, Body
4	N7037	1	Nose Housing
5	N7055	4	Screw, Die Holder
6	N7035	4	Stripper Shim
10	N7040	2	Bearing, Eccentric Shaft
11	N7038	1	Eccentric Shaft
12	N7039	1	Slider Block
13	N7036	1	Plunger
15	N5027	1	Screw, Punch Locking
16	N7032	1	Stripper Clamp Plate
17	N7031	1	Screw, Stripper
18	N7030	1	Stripper
	N7030-1	1	Stripper, SHN-II
19	N7033	1	Punch
	N7034	1	Punch, HSS
20	N7028	1	Die
	N7029	1	Die, HSS
21	N7063	1	Die Holder
22	N7052	1	Pinion Gear Shaft
23	N7051	1	Small Gear
24	N5054	2	Bearing
25	N7046	1	Eccentric Shaft Spacer
26	N7041	1	Large Gear
27	N7045	1	Key
28	N7049	1	Screw, Ground
29	N3006	1	Ground Wire Assy.
30	N3007	1	Ground Wire Retainer
31	N3008	2	Screw, Switch Mounting
32	N3009	1	Switch
33	N3011	1	Screw, Ground
34	N3012	2	Screw, Cord Clamp
35	N3013	1	Cord Clamp
36	N3014	1	Strain Relief
37	N3002	1	Handle
38	N3003	1	Handle Cover
39	N3004	5	Handle Cover Screw
40	N3017	2	Handle Locking Screw
41	N3016	2	Self Lock Nut for Handle
42	N7015	1	Cord With Plug
43	N7001	1	Motor Housing*
	AN7001	1	Complete Motor Housing Assy.**
44	N7058	2	Die Screw
45	N3050	2	Lock Washer
46	N7054	2	Dowel Pin
47	N7042	1	Gear Housing
48	N5024	1	Load Spring
49	N7048	1	Front Armature Bearing
50	N7068	1	Fan
51	N7047	2	Field Screw
52	N2050	2	Lock Washer
53	N7019	1	Motor Field (110V)
	N7020	1	Motor Field, 220V
54	N7021	1	Armature (110V)
	N7022	1	Armature, 220V
55	N5032	2	Brush Holder Cap
56	N7026	2	Brush Holder(not replaceable)
57	N5071	2	Field Spring
58	N3048	1	Rear Armature Bearing
59	N7044	2	Carbon Brush
60	N3059	1	Button Plug

* Includes: N7026

** Includes: N7001, N3002, N3003, N3004, N3016, N3017, N3012, N3013, N5032, N7026

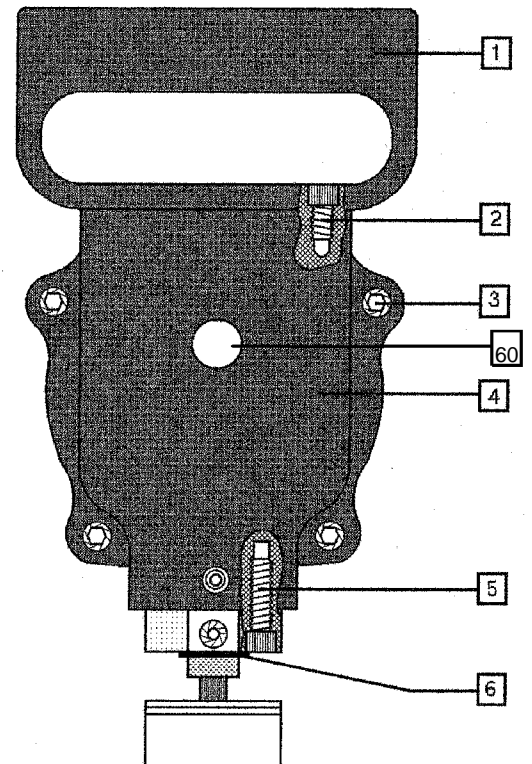
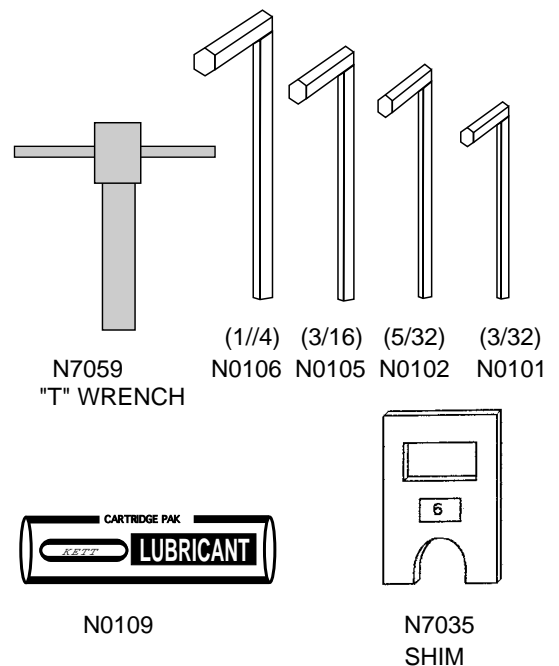
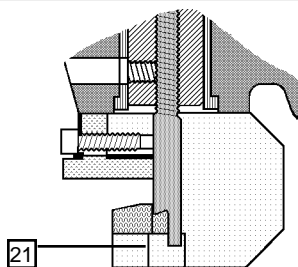
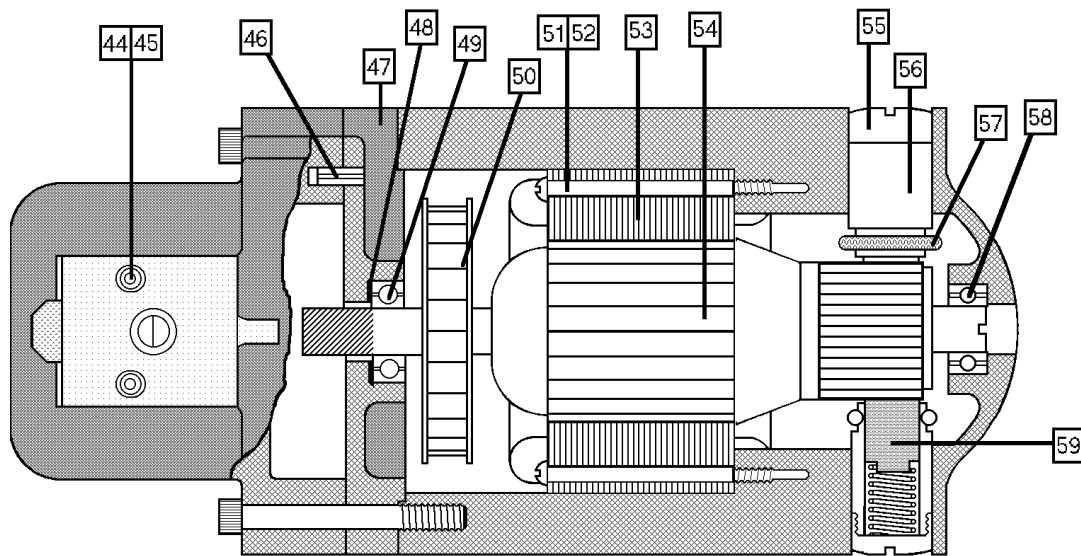
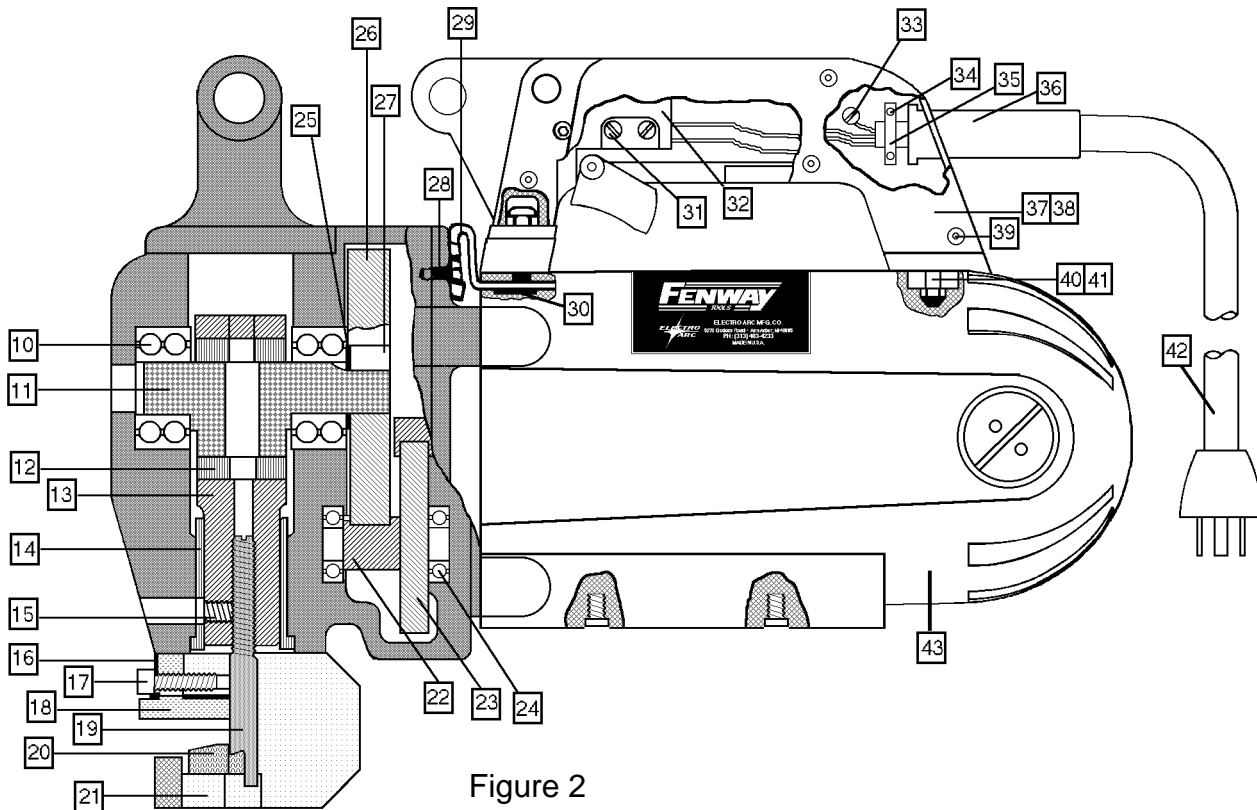

Figure 1

ACCESSORIES





NOTE: ENGINEERING CHANGE
 NEW DIE HOLDER (21) IS SELF ALIGNING AND
 DOES NOT REQUIRE DIE ADJUSTING BLOCK (9)

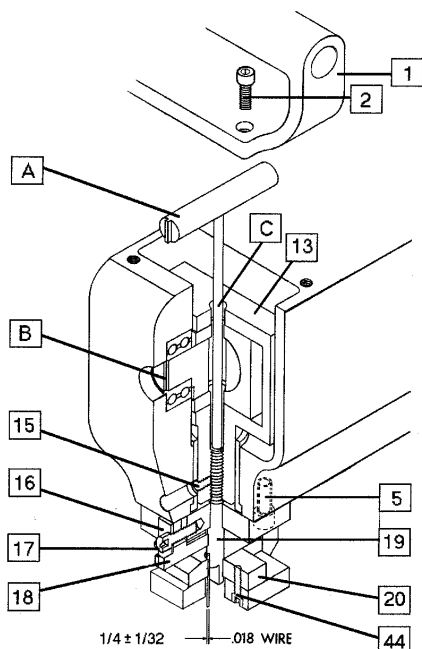

FIGURE 4

CAUTION:

DISCONNECT POWER CORD BEFORE ATTEMPTING ANY ADJUSTMENTS TO PUNCH AND DIE

TABLE A	
STOCK THK.	SHIMS REQ.
3/8	0
5/16	1
1/4	2
3/16	3
1/8	4

PUNCH AND DIE DISASSEMBLY

1. Remove four #2 screws and #1 handle. Remove button plug (60).
2. Using key "A" on "T" wrench in eccentric shaft slot "B", turn eccentric shaft until plunger #13 is at bottom of stroke, aligning wrench channel "C" and #15 set screw for access. When slot "B" is as shown in diagram, punch is at the top or bottom of stroke.
3. Loosen #17 stripper screw.
4. Remove #44 die screws (2) and #20 die.
5. Using "T" wrench per illustration, unscrew #19 punch from #13 plunger.

PUNCH AND DIE ASSEMBLY

1. Screw punch into plunger with "T" wrench. Adjust cutting edge of punch to $1/4 \pm 1/32$ above floor of die holder per illustration (die removed.)
2. Tighten setscrew #15 while rocking punch slightly with "T" wrench to seat set screw firmly against flat on threaded end of punch. Tighten set screw securely.
3. Replace #20 die and two #44 screws, leaving screws not fully tightened. Insert .018 pin between die and punch at front per illustration, slide against pin and punch and tighten two #44 screws.
4. Retighten stripper screw, first adjusting the number of #6 shims per table A.
5. Turn eccentric shaft through one full revolution and reassemble #1 handle and button plug (60) before reconnecting power cord.

LUBRICANT

After 30 hours of operation or whenever punch or die are removed, remove #1 handle and drop 6 or 8 drops of heavy gear oil (SAE 90 or 140) into hole on top of #13 plunger ("C") turn machine over with "T" wrench to distribute oil and repeat procedure three more times. Drop 6 or 8 drops of same oil into access hole for #15 setscrew. Replace #1 handle, lay nibbler on side and run for several seconds to distribute oil. Check motor brushes for excessive wear.

After 100 hours of operation or every 6 months, remove motor brushes and four nose housing bolts #3 (see parts illustration), remove and pry apart #4 nose housing and # 47 gear housing. Remove old grease and relubricate gears with Fenway special grease. Reassemble and turn nibbler over with "T" wrench before connecting power.

NOTE:

FURTHER DISASSEMBLY REQUIRES SPECIAL TOOLING AND PROCEDURE AND MAY RESULT IN DAMAGE WHICH WILL NOT BE REPAIRED UNDER WARRANTY. RETURN TOOL TO AUTHORIZED KETT/FENWAY SERVICE FACILITY IF FURTHER DISASSEMBLY IS NECESSARY.