

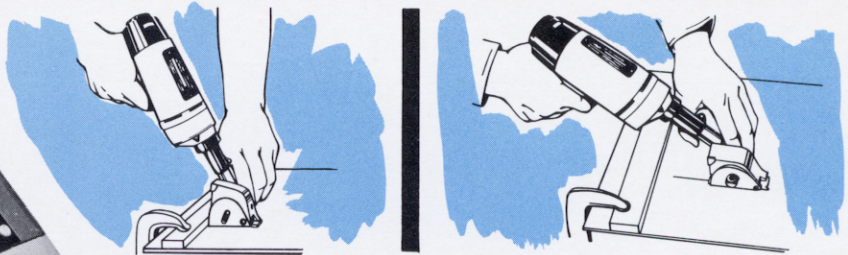

TOOL COMPANY
CINCINNATI, OHIO 45227

LIGHT PANEL SAW

MODEL KS-21AM



Safe, accurate plunge cutting

The tool is held in upright position while you bring the blade into perfect starting alignment. The guard only is against the panel — the blade cannot accidentally mar the surface. The handle is lowered pushing the blade into the panel exactly where you want it — starting the cut. The back stop shown prevents any tendency of backward movement when plunging. The guard rides smoothly over the panel surface as you continue cutting your pattern. When the cut is finished, the guard automatically drops down to cover the blade.

- **Double Insulated**
can be safely used under most conditions.

- **Variable Speed**
adjust the speed of the saw to suit the material being cut.

- **Side Handle**
for perfect weight distribution and ease of handling.

- **Plunge Cuts**
made easy with a spring loaded retractable blade guard to protect the operator.

The perfect tool for panel cutting — compact, sturdy, powerful and easy-to-use. The especially designed guide enables any operator to follow contours and cut shapes of 6" radius or larger in minimum time. Leaves smooth, milled edges that need no sanding or deburring — they're finished when you are.

The retractable blade guard facilitates accurate, safe plunge cuts by holding the blade away from the work until it is in perfect cutting position. The guard automatically springs back in place when cut is finished. Prevents personal injuries and accidental marring of panel surfaces!

The KS-21AM cuts plastic and other soft rigid materials up to $\frac{1}{4}$ " thick; aluminum up to $\frac{3}{16}$ " thick; intermittent cuts in mild steel up to 16 gauge.

Powered by a 115 volt, 4 amp motor features anti-friction bearings and double insulation. 1200 maximum RPM with variable speed control permits selection of speed best suited for the job at hand.

Standard equipment includes three $1\frac{1}{4}$ " x 44 tooth blades and three $1\frac{1}{2}$ " x 60 tooth blades and adjusting wrenches. 22, 44, and 60 tooth blades in both the $1\frac{1}{4}$ " and $1\frac{1}{2}$ " diameters are available.

THE KETT TOOL COMPANY

5055 Madison Road • Cincinnati, Ohio 45227 • (513) 271-0333